

**FOR  
LEASE**

## Multi-Tenant Rear Load Office/Warehouse Space

974 Explorer Cove  
Altamonte Springs, FL 32701



### **CONTACT**

Vincent F. Wolle, CCIM, SIOR  
407.448.1823 *mobile*  
CREManager@Gmail.com

#### **Results Real Estate Partners, LLC**

*Licensed Commercial Real Estate Brokers*  
108 Commerce Street, Suite 200  
Lake Mary, Florida 32746

407.647.0200 *main*  
407.647.0205 *fax*

**www.ResultsREPartners.com**

### **PROPERTY HIGHLIGHTS**

- 40,097 SF Multi-Tenant Rear Loading Warehouse
- Block and Metal Construction with 20' Clear Height
- Grade Level Doors (12'-14' wide doors by 14' tall)
- Covered Truck Well Access with Ample Parking
- Wet Fire Protection System, 3 Phase Power
- 2021 Renovation in place
- Building Signage Available
- 5 Year Lease Term Minimum
- Suite 132: 3,000 SF (800 Office, 2,200 WH, 1 Dock, 1 Grade) \$10.50 NNN
- Suite 124: 5,000 SF (1,200 Office, 4,800 WH, 1 Grade) \$10 NNN

This information is from sources we deem reliable and is subject to prior sale, lease, withdrawal without notice, or change in prices, rates, or conditions. No representation is made as to the accuracy of any information furnished.

**FOR  
LEASE**

# Multi-Tenant Rear Load Office/Warehouse Space

974 Explorer Cove  
Altamonte Springs, FL 32701

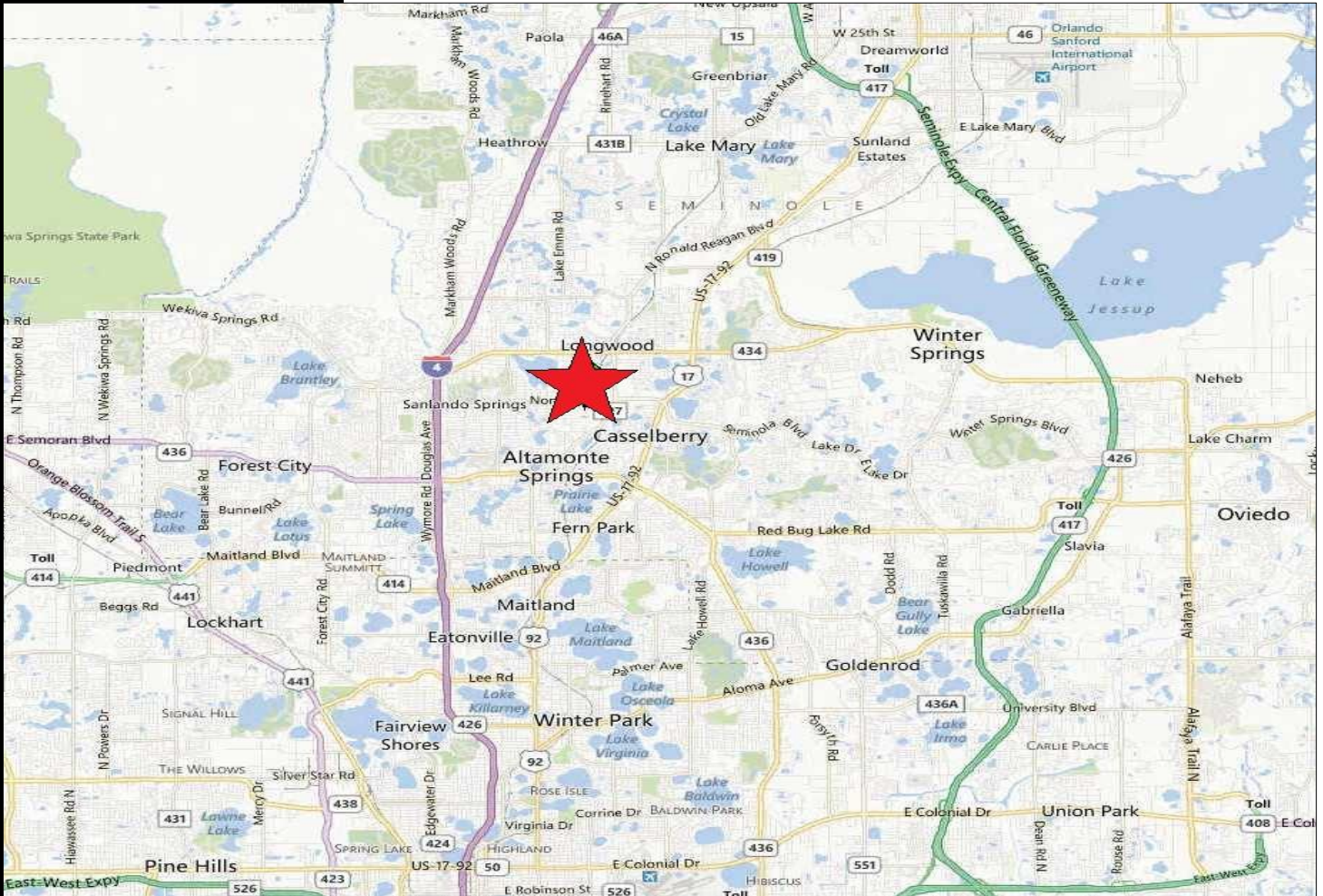

## **CONTACT**

Vincent F. Wolle, CCIM, SIOR  
407.448.1823 *mobile*  
CREManager@Gmail.com

**Results Real Estate Partners, LLC**  
*Licensed Commercial Real Estate Brokers*  
108 Commerce Street, Suite 200  
Lake Mary, Florida 32746

407.647.0200 *main*  
407.647.0205 *fax*

[www.ResultsREPartners.com](http://www.ResultsREPartners.com)



This information is from sources we deem reliable and is subject to prior sale, lease, withdrawal without notice, or change in prices, rates, or conditions. No representation is made as to the accuracy of any information furnished.

**FOR  
LEASE**

# Multi-Tenant Rear Load Office/Warehouse Space

974 Explorer Cove  
Altamonte Springs, FL 32701

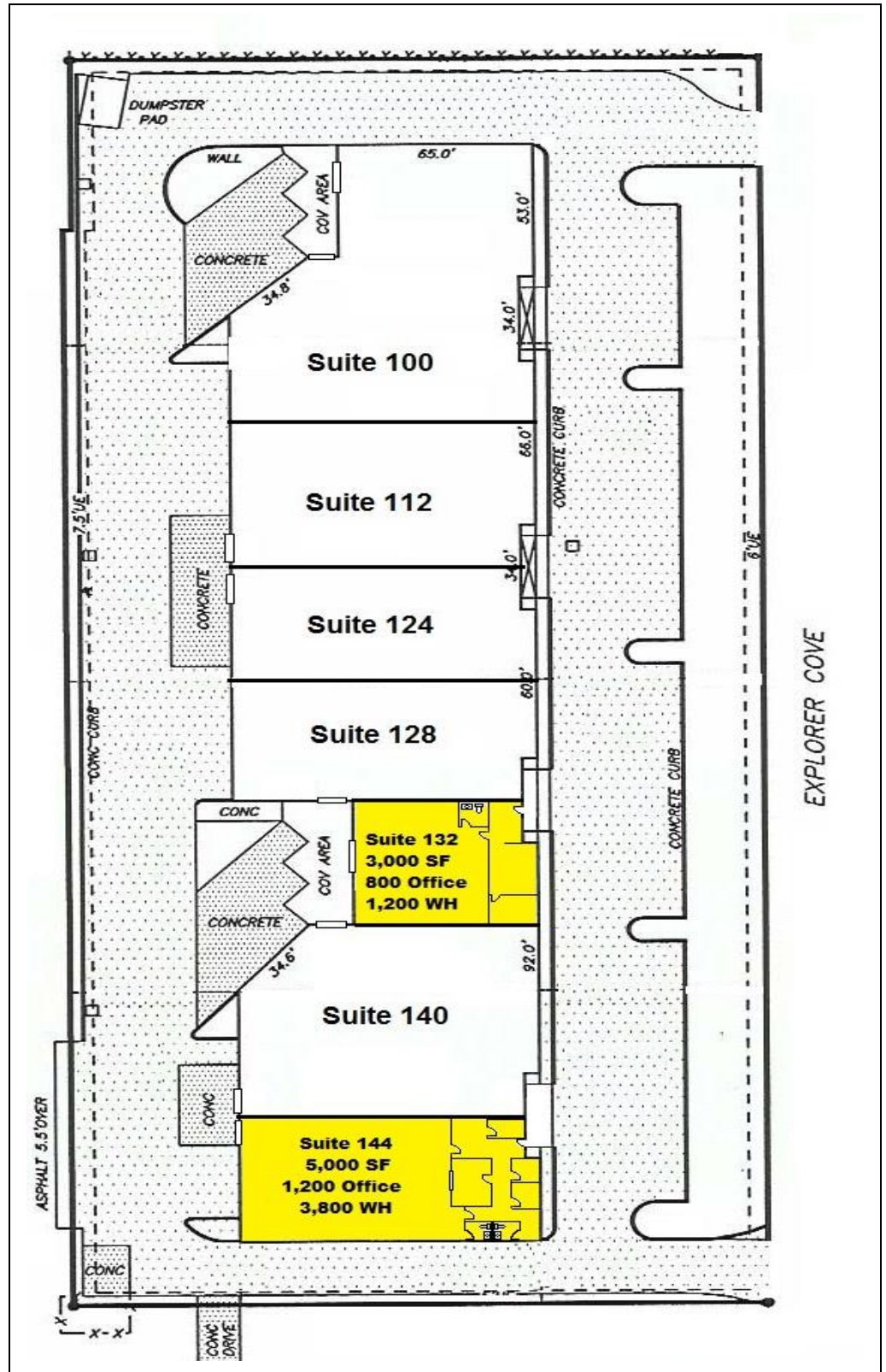

## CONTACT

Vincent F. Wolle, CCIM, SIOR  
407.448.1823 mobile  
CREManager@Gmail.com

**Results Real Estate Partners, LLC**  
Licensed Commercial Real Estate Brokers  
108 Commerce Street, Suite 200  
Lake Mary, Florida 32746

407.647.0200 main  
407.647.0205 fax

[www.ResultsREPartners.com](http://www.ResultsREPartners.com)

This information is from sources we deem reliable and is subject to prior sale, lease, withdrawal without notice, or change in prices, rates, or conditions. No representation is made as to the accuracy of any information furnished.