

**FOR  
LEASE**

## **GIRON INDUSTRIAL PARK**

**GRADE LEVEL INDUSTRIAL BAYS**

**5250-5257 GIRON CIRCLE  
KISSIMMEE, FL 34758**



### **PROPERTY HIGHLIGHTS**

- 39,700 SF (Rear Loading) on 4 Acres Zoned PD (Osceola County)
- 2008 Construction with 24' clear height and 12'x14' grade level access
- 5 Units available ranging from 1,500 SF to 4,500 SF (See Site Plan)
- 60' Deep bays, ADA bathroom, 3 phase power, covered storefront access
- Tenant signage at each unit, exhaust fans, and warehouse windows
- Most units have about 10%+/- of office, except unit 5250 which has 3800 SF+/- of office (2 story unit) with "High-End Finishes."
- Ample Parking (77 Spaces) or 2/1000 parking ratio
- Located in Osceola County Industrial Submarket close to I-4, the Florida Turnpike, 192, HW 17 and off of S. Poinciana Blvd and close to Disney.
- OPEX are currently at \$3.78 PSF

### **CONTACT**

**Vincent F. Wolle, CCIM, SIOR**  
407.448.1823 *mobile*  
CREManager@Gmail.com

**Results Real Estate Partners, LLC**  
*Licensed Commercial Real Estate Brokers*  
108 Commerce Street, Suite 200  
Lake Mary, Florida 32746

407.647.0200 *main*  
407.647.0205 *fax*

[www.ResultsREPartners.com](http://www.ResultsREPartners.com)

**Lease Rate: STARTING AT \$14.50 NNN (5 Year Lease Terms)**

This information is from sources we deem reliable and is subject to prior sale, lease, withdrawal without notice, or change in prices, rates, or conditions. No representation is made as to the accuracy of any information furnished.

**FOR  
LEASE**

# **GIRON INDUSTRIAL PARK**

**GRADE LEVEL INDUSTRIAL BAYS**

**5250-5257 GIRON CIRCLE**

**KISSIMMEE, FL 34758**



**RESULTS**  
REAL ESTATE PARTNERS, LLC

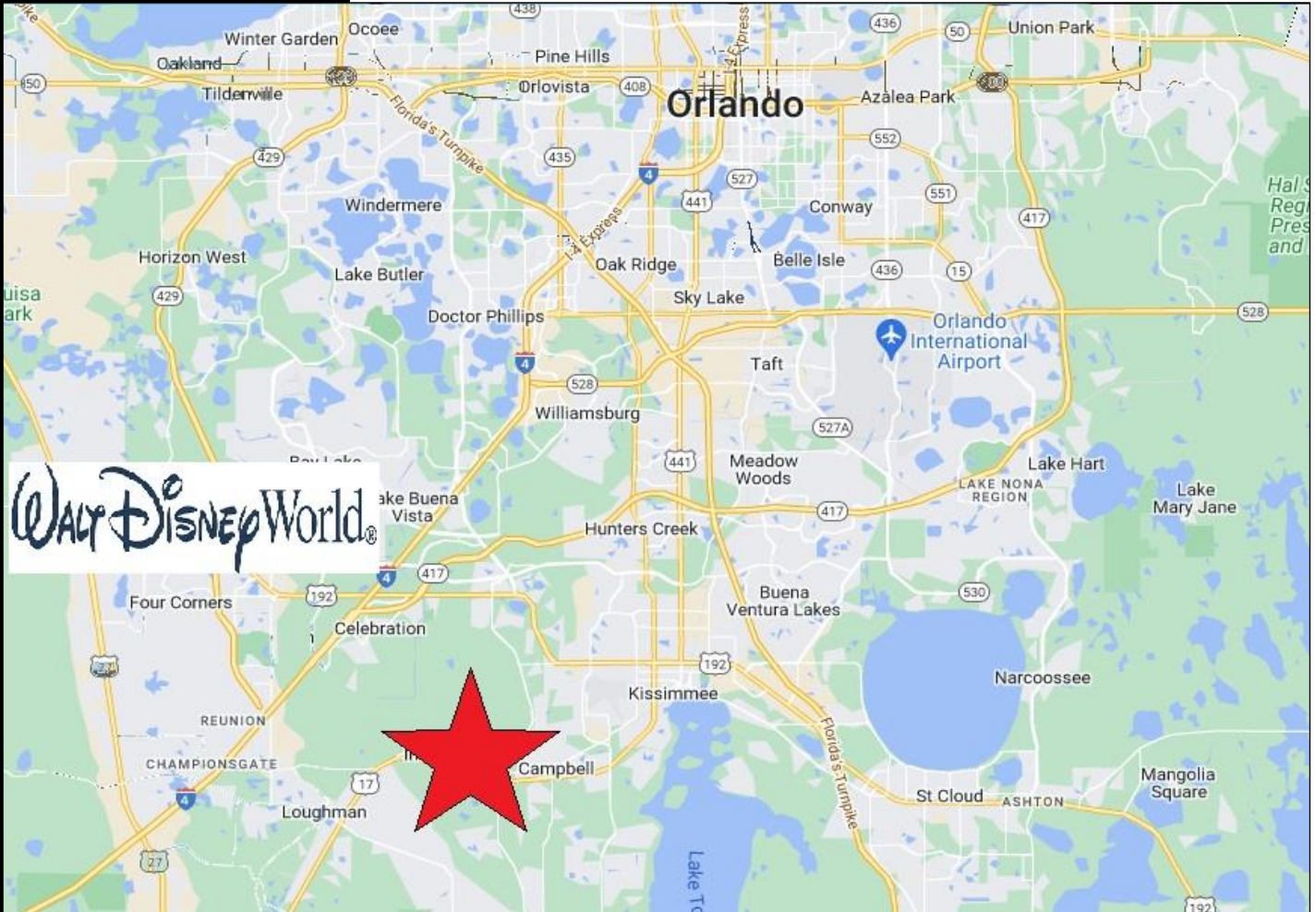

## **CONTACT**

**Vincent F. Wolle, CCIM, SIOR**  
407.448.1823 *mobile*  
CREManager@Gmail.com

**Results Real Estate Partners, LLC**  
*Licensed Commercial Real Estate Brokers*  
108 Commerce Street, Suite 200  
Lake Mary, Florida 32746

407.647.0200 *main*  
407.647.0205 *fax*

[www.ResultsREPartners.com](http://www.ResultsREPartners.com)



This information is from sources we deem reliable and is subject to prior sale, lease, withdrawal without notice, or change in prices, rates, or conditions. No representation is made as to the accuracy of any information furnished.

**FOR  
LEASE**

**GIRON INDUSTRIAL PARK**

**GRADE LEVEL INDUSTRIAL BAYS**

**5250-5257 GIRON CIRCLE  
KISSIMMEE, FL 34758**



**SITE PLAN**

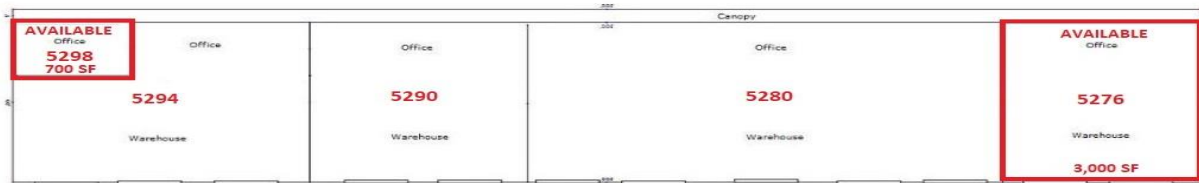

AVAILABLE

Building One Floor Plan



Building Two Floor Plan

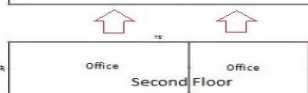

Building Three Floor Plan

This information is from sources we deem reliable and is subject to prior sale, lease, withdrawal without notice, or change in prices, rates, or conditions. No representation is made as to the accuracy of any information furnished.